



20 FLYING CLOUD



**FLYING CLOUD TRAVEL TRAILERS: 7 FLOORPLANS, 19 – 28**

When you're ready to take a break from the great outdoors, the Flying Cloud invites you inside with the flair of modern design. From fabrics to fixtures to cabinetry, the Flying Cloud line reflects your taste with clean,

comfortable, contemporary styling throughout. The right sized travel trailer for any adventure, the Airstream Flying Cloud travel trailer combines light weight and ruggedness with total practicality.

▼ 20 Flying Cloud Front To Back View In Burnt Sienna Interior



▲ 20 Flying Cloud Back to Front

▲ 20 Flying Cloud Bathroom

Innovative storage solutions and multi-function work spaces prevail throughout the living areas, like underseat storage or the additional counter space available when the sink cover is in place.

Like all Airstream trailers, every inch of a Flying Cloud has a functional purpose, and not one of those inches was built for planned obsolescence. Count on the Airstream Flying Cloud to last far longer than its boxy competitors, all while enjoying less of an impact at the pump and better stability on the road.

So no matter if you're a first-time Airstreamer or seasoned veteran of the road, the Flying Cloud gets you on your way to your next adventure in contemporary style, luxurious comfort, and long-lasting value.





## **TIRED OF COMPANIES TRUMPETING THEIR NEW-FOUND “GREEN-NESS”? US TOO.**

So we’re happy to note that we’re still taking the same environmentally friendly approach that has sustained us, and our planet, for nearly 80 years. Simply put, Airstream has been green as long as it has been silver.

Airstreams are designed to spend time on the road, not in the landfills. As such, nearly 70% of all Airstream trailers ever produced are still on the road! While other products are designed to wear out, Airstreams are designed to be handed down through the generations.

We also work with nature, not against it. Airstream’s founder, Wally Byam, knew that a low profile and a rounded, slippery shape would make for better towing in every respect. As a result, Airstreams enjoy a 20% advantage in

towing efficiency over standard “white box” trailers. And over the life of your Airstream, that’s a lot of fuel saved.

And should your Airstream come to the end of its life after many decades of service, its primary components (aluminum, steel, and wood) are easily recycled.

So go ahead and enjoy your Airstream with a sense of global responsibility, and comfort in the fact that you are adventuring in one of the most environmentally friendly travel trailers in the world. And always remember that Airstreamers leave a place better than they found it. *Silver is indeed Green.*

# FLYING CLOUD

## FLYING CLOUD TECHNICAL SPECIFICATIONS

	19	20	23	23FB	25FB	27FB	28
Exterior Length	19'2"	20'10"	23'	23'9"	25'11"	28'	27'11"
Width Exterior	8'	8'	8'	8'	8'5-1/2"	8'5-1/2"	8'5-1/2"
Width Interior	7'7"	7'7"	7'7"	7'7"	8'1"	8'1"	8'1"
Height Exterior w/A/C	9'5"	9'5"	9'5"	9'5"	9'7"	9'7"	9'7"
Height Interior w/A/C	6'4.5"	6'4.5"	6'5"	6'5"	6'5"	6'5"	6'5"
Hitch Ball Height	17-3/4"	17-3/4"	17-3/4"	17-3/4"	17-3/4"	17-3/4"	17-3/4"
Hitch Weight w/o Options Or Variable Weight	570	640	730	500	760	775	950
UBW (Unit Base Weight)	3,778	4,250	4,760	4,810	5,621	5,746	5,771
NCC (Net Carrying Capacity) w/o Options Fluids Or Cargo	722	750	1,240	1,190	1,679	1,854	1,529
GVWR (Gross Vehicle Weight Rating) (U.S.)	4,500	5,000	6,000	6,000	7,300	7,600	7,300
Water Tank w/Drain Valve	23	23	30	39	39	39	39
Blackwater Tank (Gal)	18	18	18	18	39	39	35
Graywater Tank (Gal)	21	21	21	30	37	37	37
Water Heater (Gal)	6	6	6	6	6	6	6
A/C w/Heat Pump (BTU)	13,500	13,500	13,500	13,500	13,500	15,000	15,000
Furnace w/Electric Ignition (BTU)	16,000	18,000	18,000	18,000	25,000	25,000	30,000
LPG (Lbs) (2-30# Tanks)	60	60	60	60	60	60	60
Deep Cycle Battery (Lead Acid)	2	2	2	2	2	2	2
Sleeping Capacity	2-4	2-4	2-5	2-4	2-4	2-4	2-5

Please visit [www.airstream.com](http://www.airstream.com) to see a full set of model specifications, floorplans, features and options, and to find your nearest Airstream dealer.

## FLYING CLOUD FLOORPLANS

### 19 FLYING CLOUD BAMBI

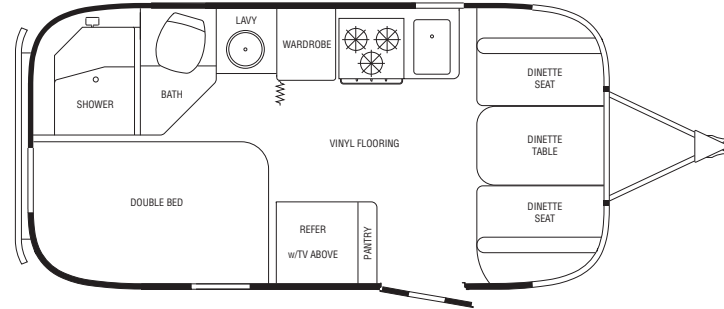

### 20 FLYING CLOUD

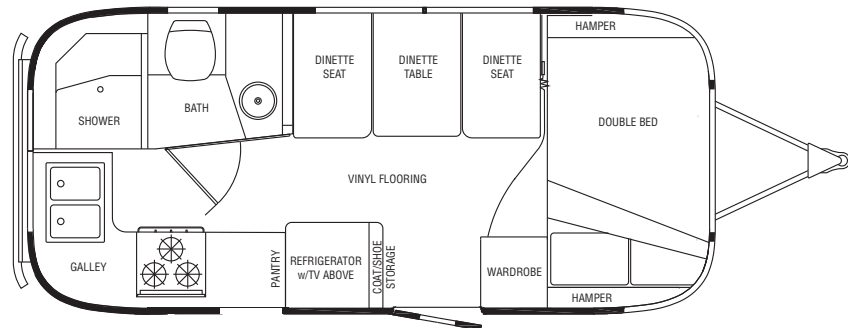

### 23 FB FLYING CLOUD

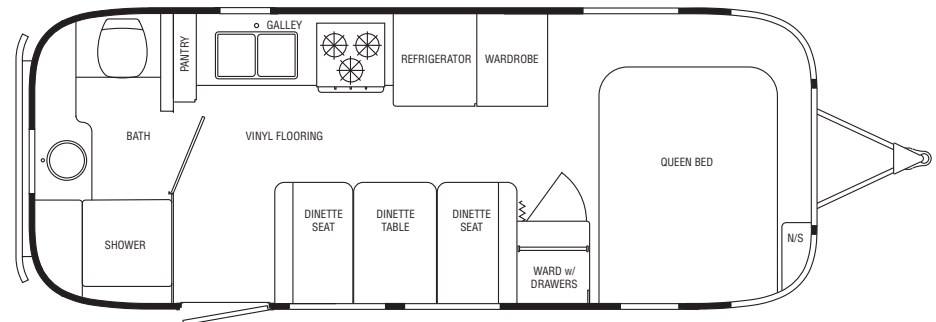



23 FLYING CLOUD

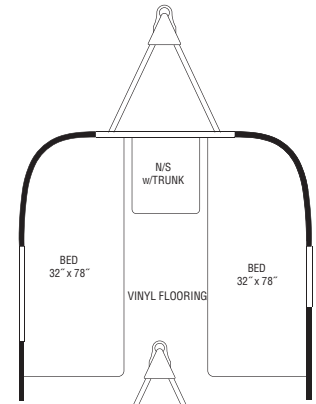
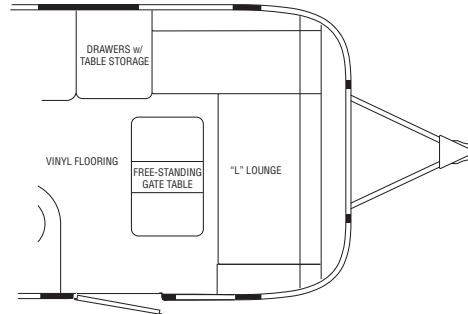
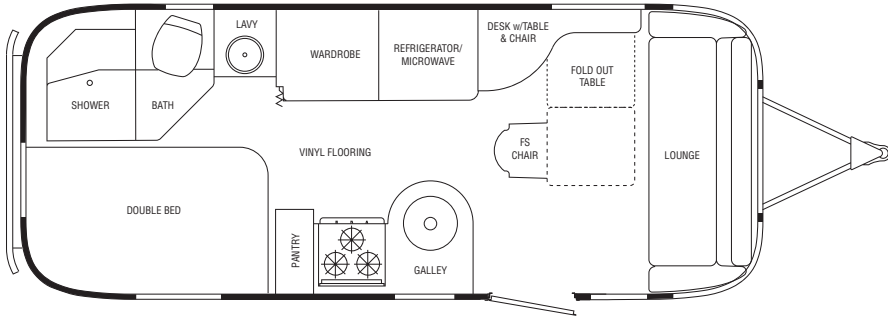

27 FB FLYING CLOUD

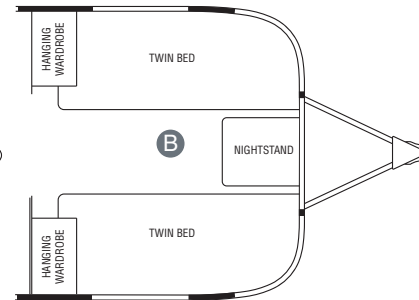
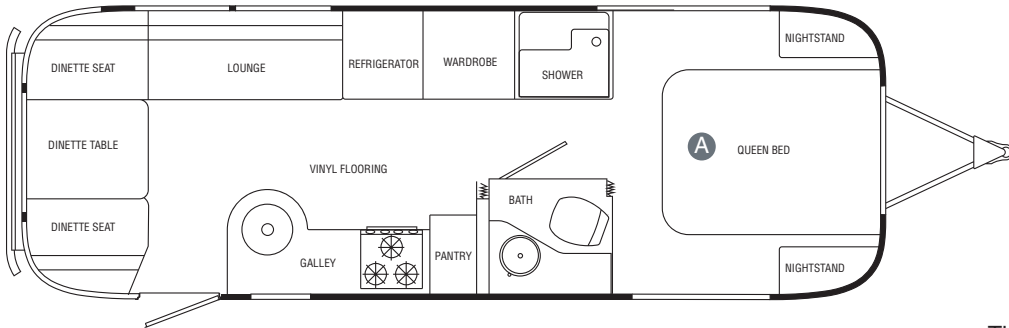

The 27 FB Flying Cloud offers two

bedroom floorplan options:

- A** A queen size bed with two wardrobes
- B** Two twin size beds with nightstand and trunk storage

28 FLYING CLOUD

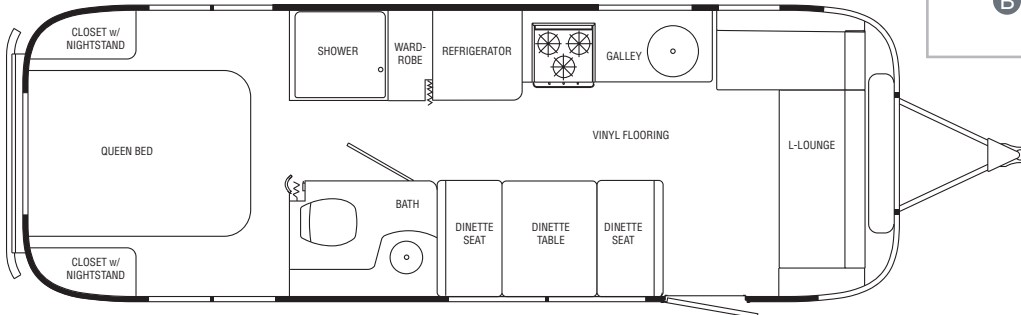

25 FB FLYING CLOUD

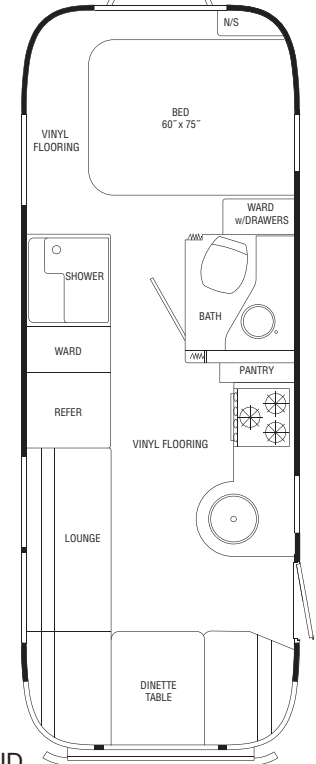

**AIRSTREAM**





# AIRSTREAM

## TRAVEL TRAILERS



### TO THE RESTLESS SPIRIT

The Airstream Travel Trailer beckons to those driven by an insatiable desire to see more, to do more, and to learn more. It calls to those who understand the allure of the open road, and the discovery of what lies beyond the next bend. And, it appeals to those who value independence and inspired design, and to those who recognize the quality and craftsmanship that have allowed one brand to stand the toughest test of all – *TIME*.

### ADVENTURE, INSPIRED BY AIRSTREAM

Airstream, Inc.  
419 West Pike Street  
Jackson Center, OH  
45334 USA  
937-596-6111  
[www.airstream.com](http://www.airstream.com)



Product information, specifications, and photography in this brochure were as accurate as possible at time of printing. Photographs may contain some features that are optional on your vehicle. Since we continually strive to improve our products, actual products may differ. Prices and specifications are subject to change without notice. All capacities are approximate and dimensions are nominal. Some features or options may be different or unavailable in Canada.

Vehicle Loading – Every effort has been made to provide the greatest number of options for the recreation vehicle owner. Along with these choices comes the responsibility to manage the loads that are imposed by the choices so that they remain within the manufacturer's specified chassis weight limits. Do not overload the recreation vehicle.

Dry Weights – Based on standard features; optional equipment not included. Net carrying capacity (NCC) determined by subtracting unloaded vehicle weight (UVW) from gross vehicle weight (GVWR) and includes fluids, options, and cargo. Liquid capacities and weights are approximations only.

Warning – This information is intended as a guide only. Weights of individual vehicles may vary. Consult your owner's manual for complete loading, weighing, and towing instructions.

**THOR**  
INDUSTRIES, INC.

All content and images © Airstream 2009

Travel Trailers 08/09 10K