

AIRSTREAM™

75 YEARS OF ADVENTURE AND DISCOVERY

"Part of the fun of being an Airstreamer is you have the icon. It has become an American icon. And people recognize it immediately."

Jim Haddaway, president of Wally Byam Caravan Club International



2007

Airstream Safari FEATURES

Laminated interior surfaces are attractive, hard-wearing and easy to keep clean.

Find out about these interior décor options: Stratus, Midnight Sun, Butterscotch, or Kiwi.

Cable TV and telephone outlets, satellite pre-wire & AM/FM/CD receiver system included.

Lighter than other trailers of comparable lengths for fast and easy travel.

AIRSTREAM

419 West Pike Street, P.O. Box 629
Jackson Center, Ohio 45334
Telephone: 937-596-6111
www.airstream.com

Safari Travel Trailers

When the going gets tough . . . the tough go Safari! Airstream's rugged and versatile Safari travel trailers have everything you'll ever need.

Ready to roll, Airstream's Safari line of travel trailers supply maximum convenience, comfort and practical living on-the-go for those ready to re-draw the road map - all with Airstream's inimitable design and production expertise. This is the Safari: ultralight and maneuverable yet battleship strong. Versatile and spacious yet full of all the modern conveniences. The benchmark for economy and efficiency. Safari trailers don't sacrifice comfort or convenience for quick and easy travel. There's sure to be a Safari that suits all your roaming needs.



Specifications and Floorplans



SAFARI TRAVEL TRAILER

Safari Trailers	19	20	23	25 FB	25	25 SS	28
Exterior length	19' 2"	20' 10"	23'	25' 11"	25' 11"	25' 11"	27' 11"
Width exterior	8'	8'	8'	8' 5-1/2"	8' 5-1/2"	8' 5-1/2"	8' 5-1/2"
Width interior	7' 7"	7' 7"	7' 7"	8' 1"	8' 1"	8' 1"	8' 1"
Height exterior with A/C	9' 5"	9' 5"	9' 5"	9' 7"	9' 7"	9' 7"	9' 7"
Height interior with A/C	6' 4.5"	6' 4.5"	6' 5"	6' 5"	6' 5"	6' 5"	6' 5"
Hitch ball height	17-3/4"	17-3/4"	17-3/4"	17-3/4"	17-3/4"	17-3/4"	17-3/4"
Hitch weight - without options or variable weight	480 lbs	600 lbs	600 lbs	720 lbs	860 lbs	750 lbs	830 lbs
UBW	3,680 lbs	3,965 lbs	4,460 lbs	5,210 lbs	5,065 lbs	5,380 lbs	5,495 lbs
NCC - no options, fluids, or cargo	820 lbs	1,035 lbs	1,540 lbs	2,090 lbs	1,935 lbs	1,920 lbs	1,805 lbs
GVWR	4,500 lbs	5,000 lbs	6000 lbs	7,300 lbs	7,000 lbs	7,300 lbs	7,300 lbs
Water tank with drain valve	23 gal	23 gal	30 gal	39 gal	39 gal	39 gal	39 gal
Black water tank	18 gal	18 gal	18 gal	39 gal	33 gal	18 gal	35 gal
Gray water tank	21 gal	21 gal	21 gal	37 gal	39 gal	39 gal	37 gal
Water heater with electronic ignition	6 gal	6 gal	6 gal	6 gal	6 gal	6 gal	6 gal
Air conditioner with heat strip	11,000 BTU	11,000 BTU	11,000 BTU	11,000 BTU	11,000 BTU	11,000 BTU	13,500 BTU
Furnace with electric ignition	16,000 BTU	18,000 BTU	18,000 BTU	25,000 BTU	25,000 BTU	25,000 BTU	30,000 BTU
LPG (lbs)	20 lbs	30 lbs (2)	20 lbs	30 lbs (2)	30 lbs (2)	30 lbs (2)	30 lbs (2)
Deep cycle group	2	2	2	2	2	2	2
Sleeping capacity	2-3	3-4	3-4	5-6	3-4	5-6	5-6

SAFARI 19 Bambi - with sofa option

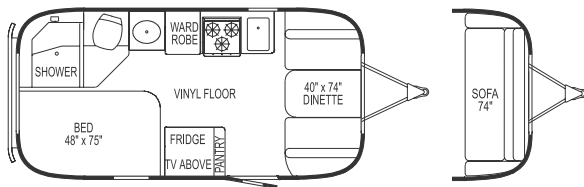

SAFARI 25

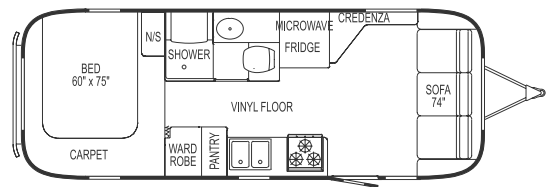

SAFARI 20

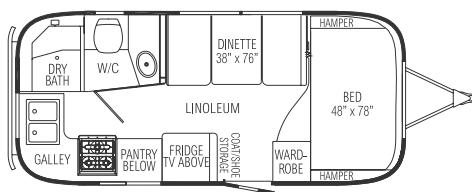

SAFARI 25 SS - (Sleeps Six)

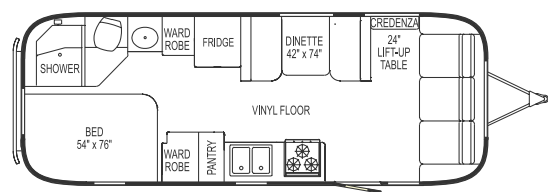

SAFARI 23 - with sofa option

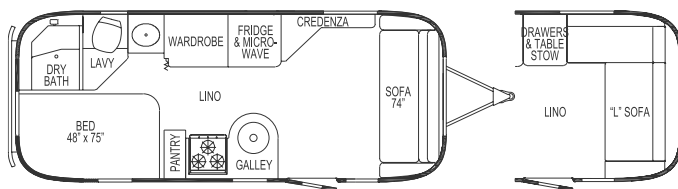

SAFARI 28

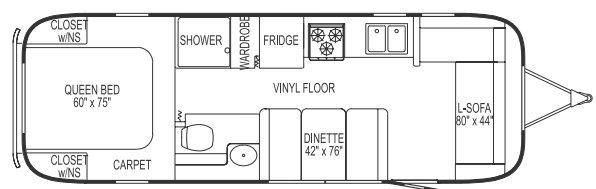

SAFARI 25 FB - with twin bed option

