



AIRSTREAM™
SEE MORE DO MORE LIVE MORE

Safari Line
Safari Sport, Safari & Special Edition



Wherever you go, whatever you do, there you are. It's simple.

We offer the Safari Travel Trailer in three configurations: Safari Sport, Safari, and Safari SE. Lightweight and rugged, each has something special to recommend it to you, whether you're a first-time Airstreamer or a seasoned veteran of the road. Every inch of an Airstream Safari has a functional purpose, and not one of those inches was built for planned obsolescence. You can buy a Safari today and join the thousands of Airstream owners still driving the original models they purchased. Two thirds of the Airstreams ever made—since the 1930's—are still on the road.

Safari Sport:

Safari Sport is an exciting new lightweight and lower cost addition to the popular Safari family, available in two easy-to-handle lengths — a 17' and a 22'. The Safari Sport has been configured from the ground up to be lightweight and easy to use — the perfect first Airstream for those new to Airstreaming, and an excellent choice for those new to the RV lifestyle altogether. The Safari Sport features convertible beds and can be towed by most smaller and midsized SUVs. Where will you go first? Get out the maps, or just swing into traffic and head wherever your mood takes you. There's no better way to begin your life of adventuring than with a Safari Sport.

Safari:

The Safari is everything you need in a travel trailer...at a very down-to-earth value. Safari gives you complete independence on the road. It's roomy on the inside yet gracefully compact on the outside. The Safari is lightweight, maneuverable, and yet battleship strong. Safari trailers don't sacrifice comfort or conveniences for quick and easy travel. They're the benchmark for economy and efficiency. Whether it's a week canoeing in Minnesota's Boundary Waters or three nights at the Monterey Jazz Festival in Northern California, your Safari will take you there.

Safari Special Edition (SE):

And then there's the Safari SE, which combines the ruggedness of the Safari and design features such as riveted panoramic windows, interior aluminum skin, and recessed halogen lighting. The look is both understated and modern, perfect for the traveler who understands that being away from home doesn't necessarily have anything to do with roughing it.

Go ahead—chase the horizon. Or unhitch your Safari and practice the long-forgotten art of relaxation.

Exterior:

Rugged on the road. The Airstream Safari's design embodies nearly 80 years of engineering expertise: the finish a result of Airstream's long experience on the highways and byways of the world. Our engineers design, refine, and make innovations in collaboration with Airstream owners world-wide who have been helping Airstream field-test products since the 1930s.

The Safari's silver curves make a lovely reflective surface for moonlight, but they're not just for looks: the aerodynamically-shaped exterior design lowers wind resistance —requiring less horsepower and approximately 20% less fuel than conventional box trailers. Monocoque construction, ultralight materials, and a low center of gravity make towing the Safari a dream.

Those curves don't mean we've cut any corners, either: nothing has been spared to create a living space that lets you relax in spaciousness and comfort. Whether you're following a balloon race in New Mexico or spending a week off-road in Idaho, no other travel trailer comes close to creating this satisfying residential living environment.

Like other Airstream Travel Trailers, the Safari is self-sufficient, so you can park it anywhere and stay awhile. Its water and fuel tanks, water heater, and furnace are seamlessly integrated into the body of the trailer, to maintain the Safari's aerodynamic shape.

Airstream's founder, Wally Byam, used to say there was no point staying home in the rocking chair. We couldn't agree more. If you've got to have one on hand, just bring it with you! With or without it, get ready for adventure and spontaneity in a Safari.



Shown with optional exterior decal.

Interior:

The Safari's interior surfaces (wood, vinyl, aluminum, and laminate) are attractive, hard-wearing, and easy to clean. Its well-appointed galley — with a sealed-burner cooktop, microwave option, and stainless steel sink with cover — easily accommodates pre-dawn poached eggs and wheat toast for two, or an after-rock-climb paella and sangria for six. Roomy storage cabinets keep all your belongings in order. Comfortable beds cushion you after a hard day of adventure and encourage a solid and restful night's sleep. The Safari can also help you stay in touch with the modern world through up-to-the-minute communication and entertainment features: telephone hookups, satellite pre-wire, and premium audio packages.



The Safari SE model comes with aluminum-framed windows that are riveted into the shell. The glass is tempered safety glass with tint and UV inhibitors. Your Safari SE will give you incredible panoramic views from the inside, and the plentiful windows maximize the interior's light and expand its sense of spaciousness. One of the most appealing things about these windows is that they truly bring the outdoors inside. The expansive windows also provide excellent airflow when they're open. Another feature of the Safari SE is our Vista View windows. These smaller windows are positioned near the top of the Airstream to bring you privacy without darkness.



Hidden inside the Safari's walls, but crucial for traveling comfort, is our residential-type 2.5" fiberglass batten insulation, which keeps the interior cool in the summer, warm in the winter, and quiet all year around. All Airstreams are completely insulated, including the floor and holding tanks.

Chose from several different interior decors to create the kind of environment that will make you feel most at home. And then, hitch up and go anywhere. At the end of the day, no matter where you are, you've arrived. Step inside. Take a deep breath. Welcome home.

Safari Sport Floorplans and Specifications

17' Sport

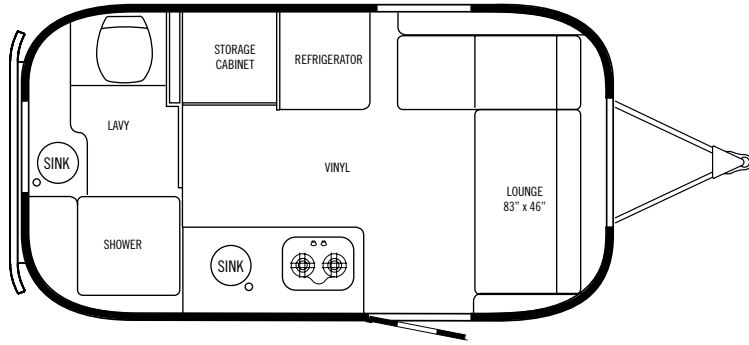

22' Sport

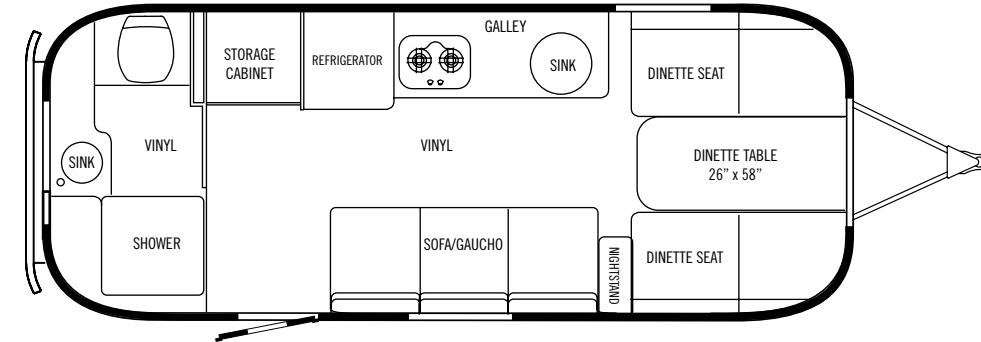

	17' Sport	22' Sport
--	--------------	--------------

Actual Length	16'8"	21'8"
Width Exterior	7'3 1/4"	7'3 1/4"
Width Interior	6'11 3/4"	6'11 3/4"
Height Exterior w/o Air Conditioner	8'3.5"	8'3.5"
Height Exterior w/Air Conditioner	8'11"	8'11"
Height Interior w/o Air Conditioner	6'5 5/8"	6'5 5/8"
Height Interior w/Air Conditioner	75"	75"
Hitch Ball Height	16.50"	17.25"
4500 lb. GVWR	N/A	Opt/ Std For CSA
4000 lb. GVWR	CSA	Std
3500 lb. GVWR	Std	N/A
13,500 A/C w/Heat Pump & Electronic Control (Carrier Air V)	Opt	Opt
Furnace - 12,000 BTU	Std	Std
Water Tank w/Drain Valve, Gallons	20	20
Black Water Tank, Gallons	18	18
Gray Water Tank, Gallons	20	20
GVWR (Gross Vehicle Weight Rating)	3500	4000
UBW (Unit Base Weight) w/o Options or Fluids	2800	3400
Hitch Weight, w/o Options or Variable Wt.	300	370
NCC (Net Carrying Capacity) w/o Options + Personal Cargo + Fluids	700	650
Sleeping Capacity	2	4
Patio Awning	Opt	Opt
Patio Awning Length	7'4.25"	12' 5.25"

Available Color Schemes

- Stratus
- Kiwi
- Oatmeal
- Sharkskin

Product information, specifications, and photography in this brochure were as accurate as possible at time of printing. Photographs may contain some features that are optional on your vehicle. Since we continually strive to improve our products, actual products may differ. Prices and specifications are subject to change without notice. All capacities are approximate and dimensions are nominal. Some features or options may be different or unavailable in Canada.

Vehicle Loading — Every effort has been made to provide the greatest number of options for the recreation vehicle owner. Along with these choices comes the responsibility to manage the loads that are imposed by the choices so that they remain within the manufacturer's specified chassis weight limits. Do not overload the recreation vehicle.

Dry Weights — Based on standard features; optional equipment not included. Net carrying capacity (NCC) determined by subtracting unloaded vehicle weight (UVW) from gross vehicle weight (GVWR) and includes fluids, options, and cargo. Liquid capacities and weights are approximations only.

Warning — This information is intended as a guide only. Weights of individual vehicles may vary. Consult your owner's manual for complete loading, weighing, and towing instructions.

Safari & Safari Special Edition Floorplans

19' Safari / Safari SE

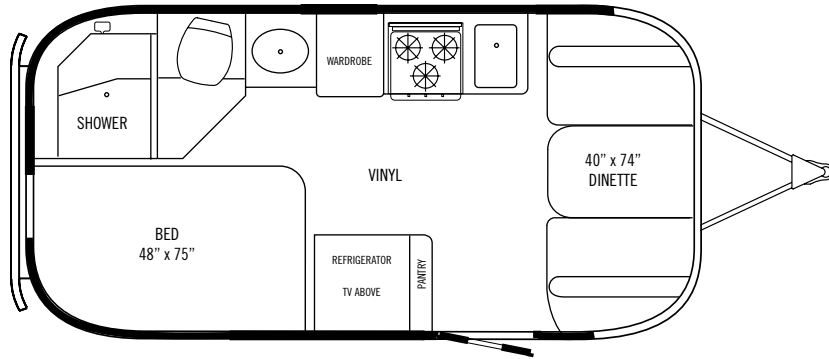

Panoramic Windows are only available on Safari SE trailers

20' Safari / Safari SE

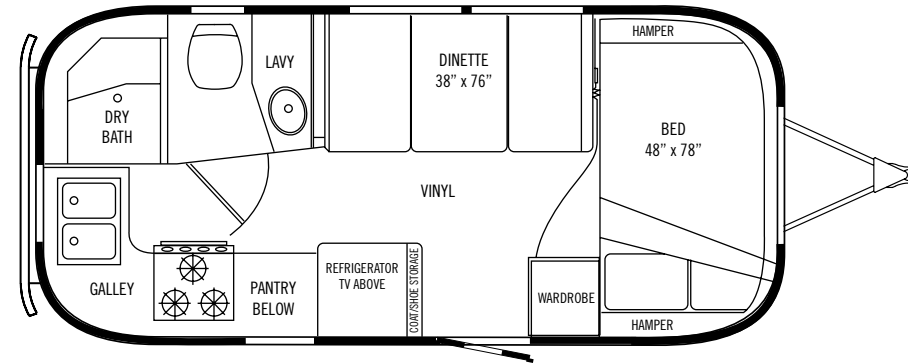

Safari & Safari Special Edition Floorplans

23' Safari / Safari SE

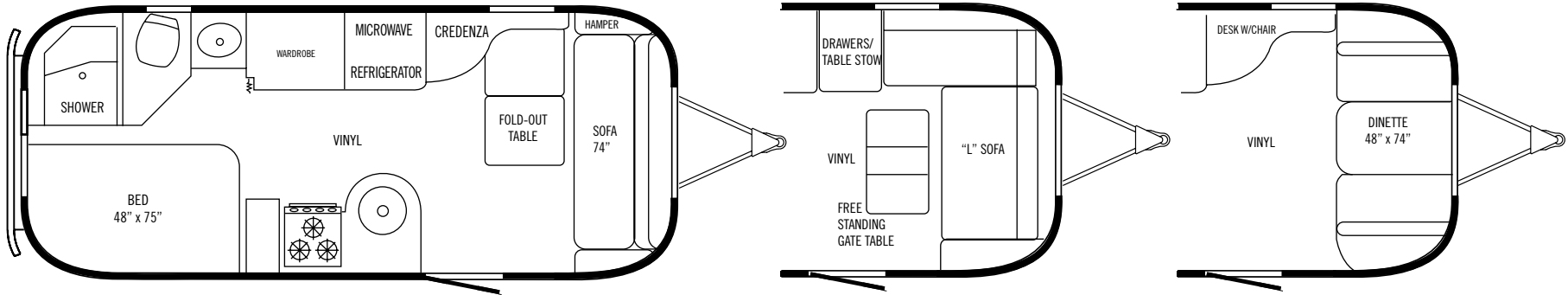

25' FB Safari / Safari SE

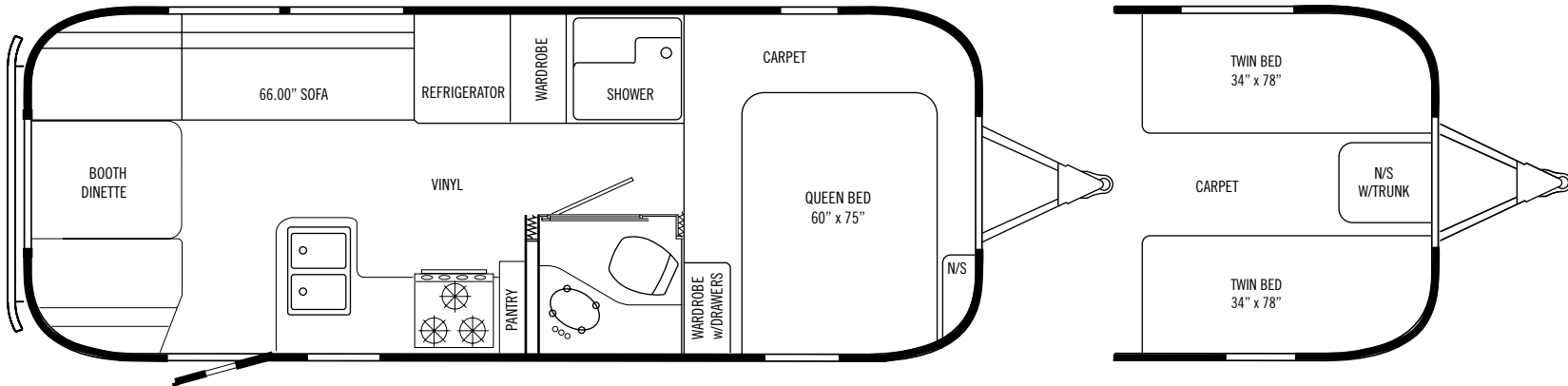

Safari & Safari Special Edition Floorplans

25' Safari / Safari SE

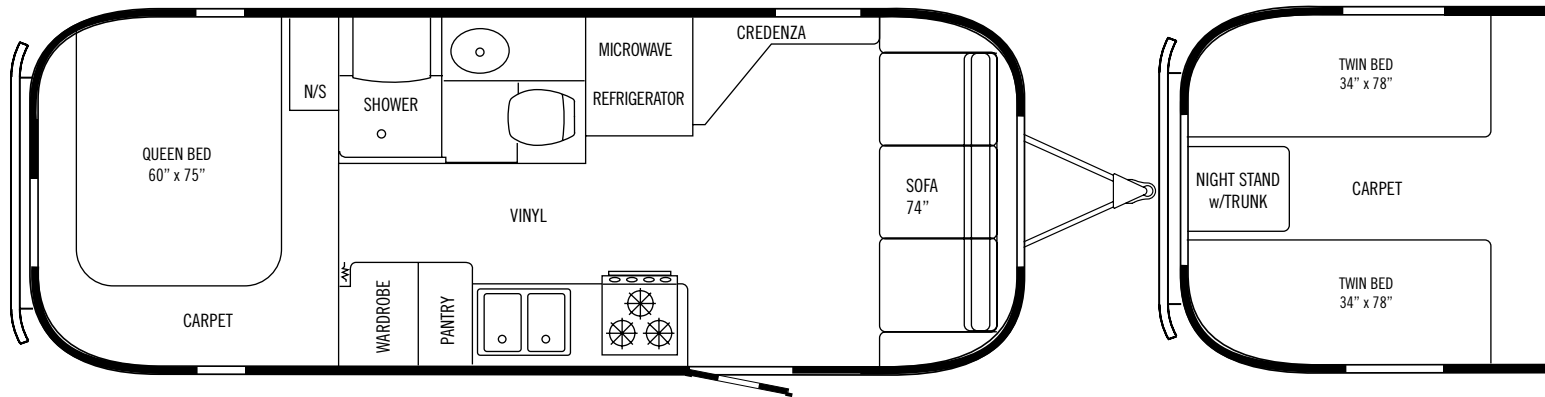

25' SS Safari / Safari SE

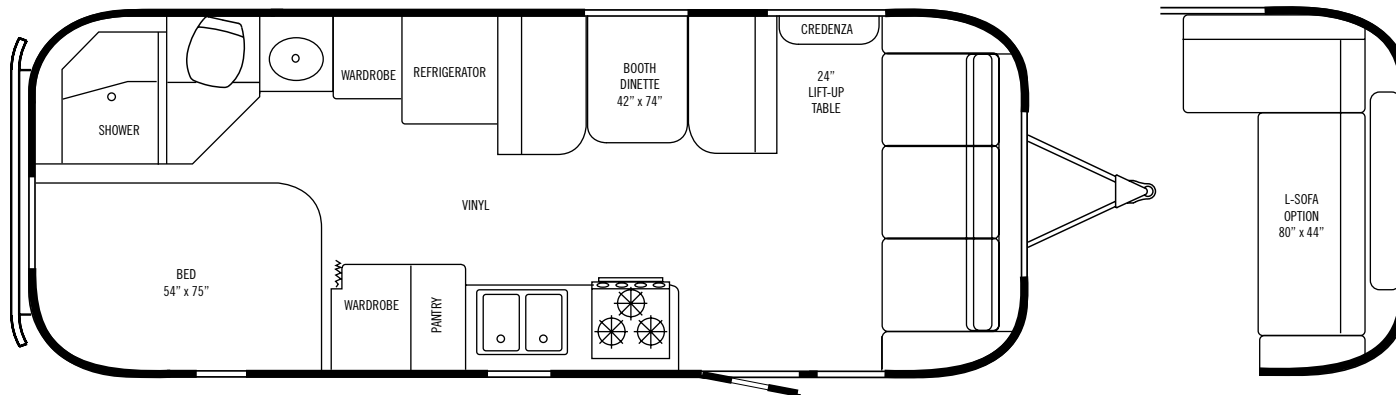

Safari & Safari Special Edition Floorplans and Specifications

27' FB Safari / Safari SE

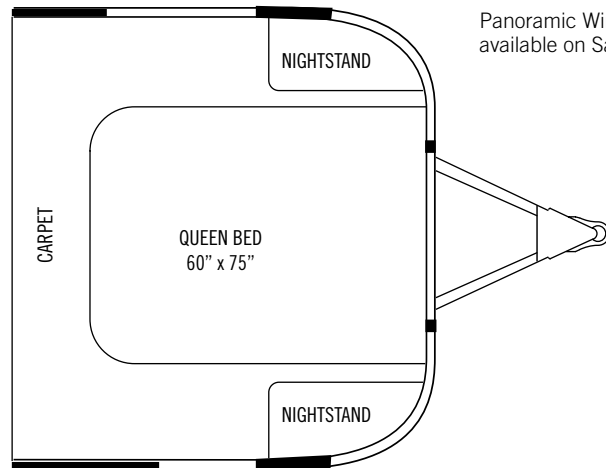
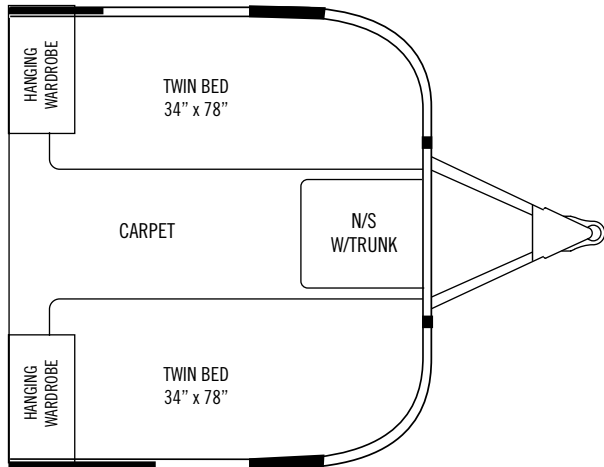
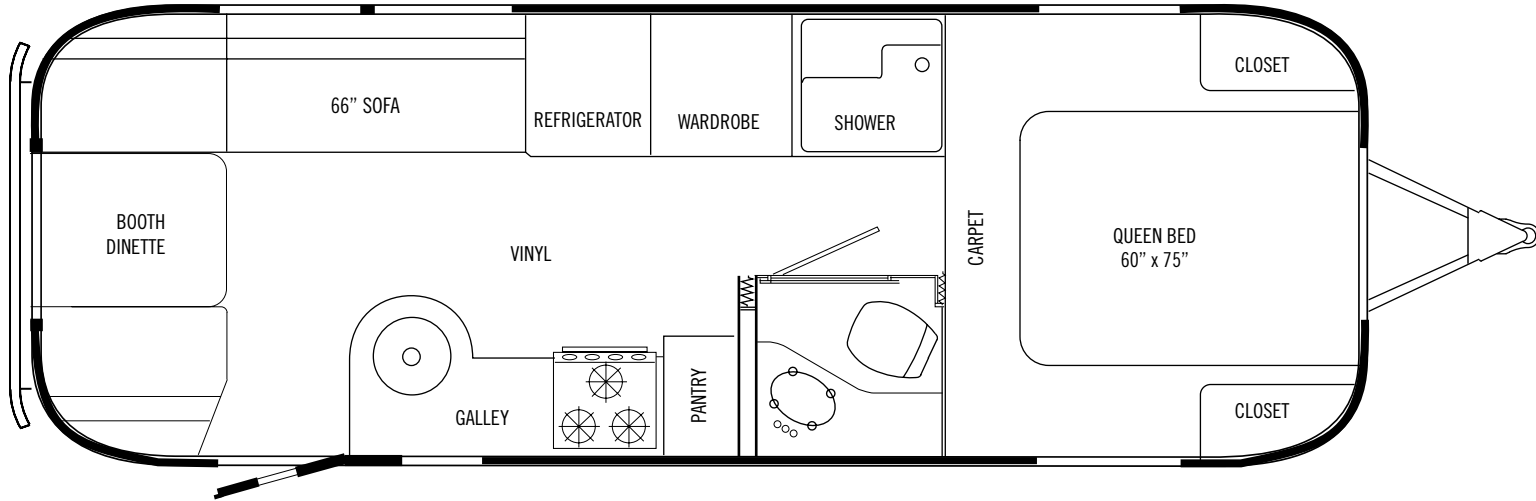

Panoramic Windows are only available on Safari SE trailers

Safari & Safari Special Edition Floorplans

28' Safari / Safari SE

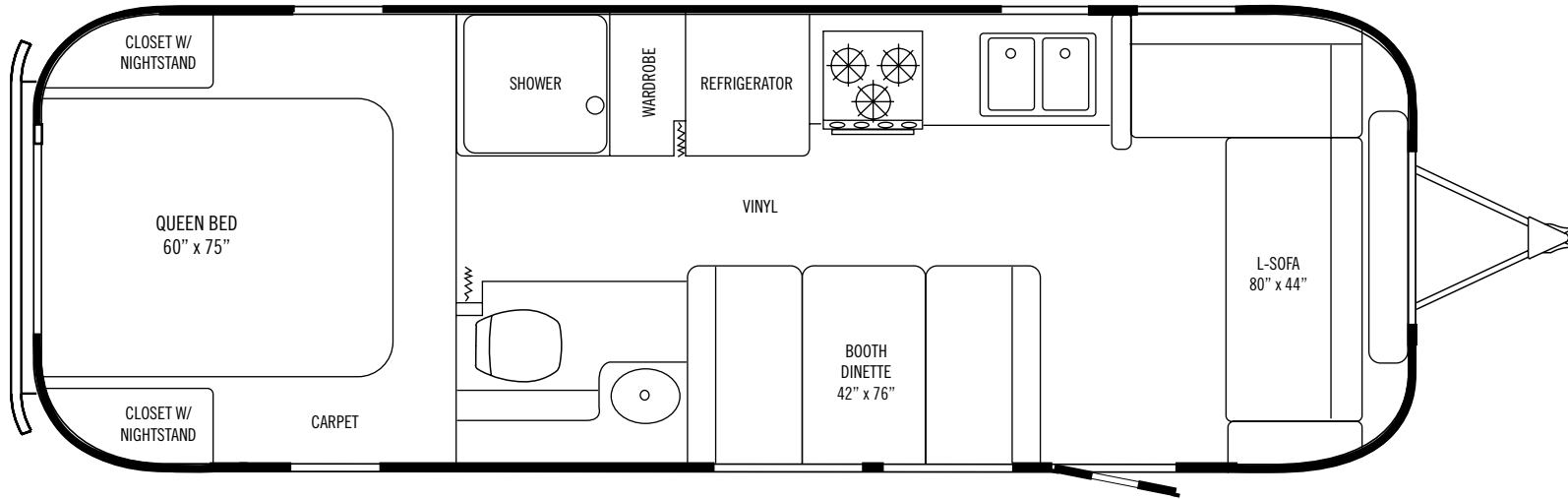

Safari Trailer Specifications

	19' Safari	20' Safari	23' Safari	25'FB Safari	25' Safari	25'SS Safari	27'FB Safari	28' Safari
Actual Length	19'2"	20'10"	23'	25'-11"	25' 11"	25' 11"	28'0"	27'11"
Width Exterior	8'	8'	8'	8'-5-1/2"	8'-5-1/2"	8'-5-1/2"	8'-5-1/2"	8'-5-1/2"
Width Interior	7'7"	7'7"	7'7"	8'-1"	8' 1"	8' 1"	8'1"	8'1"
Height Exterior w/Air Conditioner	9'5"	9'5"	9'5"	9'-7"	9' 7"	9' 7"	9'7"	9'7"
Height Interior w/Air Conditioner	6'4.5"	6'4.5"	6'5"	6'5"	6'5"	6'5"	6'5"	6'5"
Height Interior w/o Air Conditioner	6'7"	6'7"	6'7.5"	6'7.5"	6'7.5"	6'7.5"	6'7.5"	6'7.5"
Hitch Ball Height	17-3/4"	17-3/4"	17-3/4"	17-3/4"	17-3/4"	17-3/4"	17-3/4"	17-3/4"
4500 lb. GVWR	Std	N/A	N/A	N/A	N/A	N/A	N/A	N/A
5000 lb. GVWR	CSA	Std	N/A	N/A	N/A	N/A	N/A	N/A
6000 lb. GVWR	N/A	N/A	Std	N/A	N/A	N/A	N/A	N/A
7000 lb. GVWR	N/A	N/A	N/A	N/A	Std	N/A	N/A	N/A
7300 lb. GVWR	N/A	N/A	N/A	Std	N/A	Std	N/A	Std
7600 lb. GVWR	N/A	N/A	N/A	N/A	N/A	N/A	Std	N/A
11,000 A/C w/Heat Strip Manual Control - Safari	Std	Std	Std	Std	Std	Std	N/A	N/A
13,500 A/C w/Heatstrip & Manual Control - Safari	N/A	N/A	N/A	N/A	N/A	N/A	Std	Std
Furnace-w/Electronic Ignition	16000 BTU	18000 BTU	18000 BTU	25000 BTU	25000 BTU	25000 BTU	25000 BTU	30000 BTU
Water Tank w/Drain Valve Gallons	23	23	30	39	39	39	39	39
Black Water Tank Gallons	18	18	18	39	33	18	39	35
Gray Water Tank,Gallons	21	21	21	37	39	39	37	37
UBW (Unit Base Weight) w/o Options or Fluids	3680	3965	4460	5210	5065	5380	5399	5495
Hitch Weight, w/o Options	480	600	600	720	860	750	790	830
NCC (Net Carrying Capacity) w/o Options + Personal Cargo + Fluids	820	1035	1540	2090	1935	1920	2201	1805

Safari Trailer Specifications (continued)

	19' Safari	20' Safari	23' Safari	25'FB Safari	25' Safari	25'SS Safari	27'FB Safari	28' Safari
Sleeping Capacity	3 - 4	2 - 4	4	4 - 6	4	4 - 6	4 - 6	4 - 6
Available Color Schemes								
Stratus	Opt	Opt	Opt	Opt	Opt	Opt	Opt	Opt
Oatmeal	Opt	Opt	Opt	Opt	Opt	Opt	Opt	Opt
Midnight Sun	Opt	Opt	Opt	Opt	Opt	Opt	Opt	Opt
Butterscotch	Opt	Opt	Opt	Opt	Opt	Opt	Opt	Opt
Kiwi	Opt	Opt	Opt	Opt	Opt	Opt	Opt	Opt
TV/DVD Combo - 15"	Opt	Opt	Opt	Opt	Opt	Opt	Opt	Opt

Safari Special Edition (SE) Specifications

	19' Safari SE	20' Safari SE	23' Safari SE	25'FB Safari SE	25' Safari SE	25'SS Safari SE	27'FB Safari SE	28' Safari SE
Actual Length	19'2"	20'10"	23'	25'-11"	25' 11"	25' 11"	28'0"	27'11"
Width Exterior	8'	8'	8'	8'-5-1/2"	8' 5-1/2"	8' 5-1/2"	8'-5-1/2"	8'-5-1/2"
Width Interior	7'7"	7'7"	7'7"	8'-1"	8' 1"	8' 1"	8'1"	8'1"
Height Exterior w/Air Conditioner	9'5"	9'5"	9'5"	9'-7"	9' 7"	9' 7"	9'7"	9'7"
Height Interior w/Air Conditioner	6'4.5"	6'4.5"	6'5"	6'5"	6'5"	6'5"	6'5"	6'5"
Height Interior w/o Air Conditioner	6'7"	6'7"	6'7.5"	6'7.5"	6'7.5"	6'7.5"	6'7.5"	6'7.5"
Hitch Ball Height	17-3/4"	17-3/4"	17-3/4"	17-3/4"	17-3/4"	17-3/4"	17-3/4"	17-3/4"
4500 lb. GVWR	Std	N/A	N/A	N/A	N/A	N/A	N/A	N/A
5000 lb. GVWR	CSA	Std	N/A	N/A	N/A	N/A	N/A	N/A
6000 lb. GVWR	N/A	N/A	Std	N/A	N/A	N/A	N/A	N/A
7000 lb. GVWR	N/A	N/A	N/A	N/A	Std	N/A	N/A	N/A
7300 lb. GVWR	N/A	N/A	N/A	Std	N/A	Std	N/A	Std
7600 lb. GVWR	N/A	N/A	N/A	N/A	N/A	N/A	Std	N/A
13,500 A/C w/Heat Pump & Elec Control -"SE" Only	Std	Std	Std	Std	Std	Std	Std	Std
15,000 A/C w/Heat Pump & Elec Control -"SE" Only	N/A	N/A	N/A	N/A	N/A	N/A	Opt	Opt
Furnace-w/Electronic Ignition	16000 BTU	18000 BTU	18000 BTU	25000 BTU	25000 BTU	25000 BTU	25000 BTU	30000 BTU
Water Tank w/Drain Valve Gallons	23	23	30	39	39	39	39	39
Black Water Tank Gallons	18	18	18	39	33	18	39	35
Gray Water Tank, Gallons	21	21	21	37	39	39	37	37
UBW (Unit Base Weight) w/o Options Or Fluids	3680	3965	4460	5210	5065	5380	5399	5495
Hitch Weight, w/o Options or Variable Wgt.	480	600	600	720	860	750	790	830
NCC (Net Carrying Capacity) w/o Options + Personal Cargo + Fluids	820	1035	1540	2090	1935	1920	2201	1805
Sleeping Capacity	3 - 4	2 - 4	4	4 - 6	4	4 - 6	4 - 6	4 - 6
Available Color Schemes								
Stratus	Opt	Opt	Opt	Opt	Opt	Opt	Opt	Opt
Oatmeal	Opt	Opt	Opt	Opt	Opt	Opt	Opt	Opt
Midnight Sun	Opt	Opt	Opt	Opt	Opt	Opt	Opt	Opt
Butterscotch	Opt	Opt	Opt	Opt	Opt	Opt	Opt	Opt
Kiwi	Opt	Opt	Opt	Opt	Opt	Opt	Opt	Opt
SE Includes the following (Continued on the next page)	Std	Std	Std	Std	Std	Std	Std	Std

SE Includes the following (Continued on the next page)

- International Aluminum Interior Skin
- Classic Style Windows w/Rear Panoramic (FB)
- Classic Style Windows w/Front Panoramic (Rear 25FB - 27FB)
- Décor Lighting
- Brushed Aluminum Blinds

Safari SE Specifications (continued)

	19' Safari SE	20" Safari SE	23' Safari SE	25'FB Safari SE	25' Safari SE	25'SS Safari SE	27'FB Safari SE	28' Safari SE
-High Performance Water Pump								
-Cast Taillights LED 6" Oval								
-Screen Door Guards - Upper/Lower								
-13,500 A/C w/Heat Pump - Electronic Controls								
-Faucet w/Filtrations & Separate Spray								
-Galley Skylight w/Shade (25' Through 28') Only								
The following features are also unique to the Safari SE and not available on the regular Safari:								
Window Awning Package - "SE" Only	Opt	Opt	Opt	Opt	Opt	Opt	Opt	Opt
Cast Taillight - 6" LED Oval - "SE" Only	Std	Std	Std	Std	Std	Std	Std	Std
Exterior Graphics Package - "SE" Only	Opt	Opt	Opt	Opt	Opt	Opt	Opt	Opt
Skylight w/Blackout Shade - Galley - "SE" Only	N/A	N/A	N/A	Std	Std	Std	Std	Std
Screen Door Guards - Upper/Lower "SE" Only	Std	Std	Std	Std	Std	Std	Std	Std
74" Ultra Leather Sofa - "SE" Only	N/A	N/A	Opt	N/A	Opt	Opt	N/A	N/A
2nd Fantastic Fan - Exhaust Only - Manual	Opt	Opt	Opt	Opt	Opt	Opt	Opt	Opt
Control - "SE" Only								
Remote Generator Ready - "SE" Only	N/A	N/A	N/A	Opt	Opt	Opt	Opt	Opt
Premium Audio Upgrade Package: "SE" Only	Opt	Opt	Opt	Opt	Opt	Opt	Opt	Opt
Sony 10 Disc Cd Changer								
100 Watt Active Subwoofer								
Premium Audio/Video Upgrade Pkg	Opt	Opt	Opt	Opt	Opt	Opt	Opt	Opt
w/19" Or 23" TV - "SE" Only								
52w Max AM/FM/CD/DVD/CD Controller Receiver								
6.5", 2-Way Speakers (2pr)								
Active Subwoofer-100 Watt								
10-Disc CD Changer								
Omnimount Articulating Wall Bracket								
12v DC Audio Prep Jack								
600 Watt Inverter - 5 Amps AC (TV & 1	Opt	Opt	Opt	Opt	Opt	Opt	Opt	Opt
Designated Outlet) - "SE" Only								
Sirius Or XM Satellite Radio - "SE" Only	Opt	Opt	Opt	Opt	Opt	Opt	Opt	Opt
(Audio upgrade or Audio/Video upgrade required)								
Wireless External Speaker Package - "SE" Only	Opt	Opt	Opt	Opt	Opt	Opt	Opt	Opt
(Audio or Audio/Video upgrade pkg. required)								
Solar Panel Charge System: - "SE" Only	Opt	Opt	Opt	Opt	Opt	Opt	Opt	Opt
Includes:								
Glassmatt Battery - Group 24	2	2	2	2	2	2	2	2
53 Watt Solar Panel And Charge	1	1	1	2	2	2	2	2
Controller Display								
Water Pump 3.5 GPM - "SE" Only	Std	Std	Std	Std	Std	Std	Std	Std



Designed to be part of your life

AIRSTREAM 2008 See the Safari online at www.Airstream.com

AIRSTREAM™

419 West Pike Street
P.O. Box 629
Jackson Center, Ohio 45334
Tel: 937-596-6111
www.airstream.com

All content and images copyright © Airstream 2007
Selected photographs by Larry McCay www.larrymccay.com
Design by Velocity7 www.velocity7.com

THOR
INDUSTRIES, INC.